



Caution

Always disconnect power to chair before removing covers or performing any service procedures.

Step 1: Remove Back Cylinder.

- Remove upholstery.
- Remove Top Cover by removing two screws lifting up and off.
- Remove Bottom Actuator Pin by pushing Spring Tab inward and pulling pin out.
- Rotate chair back onto the seat of the chair.
- Loosen nuts and unthread Back Cylinder from Actuator Cap Assembly.

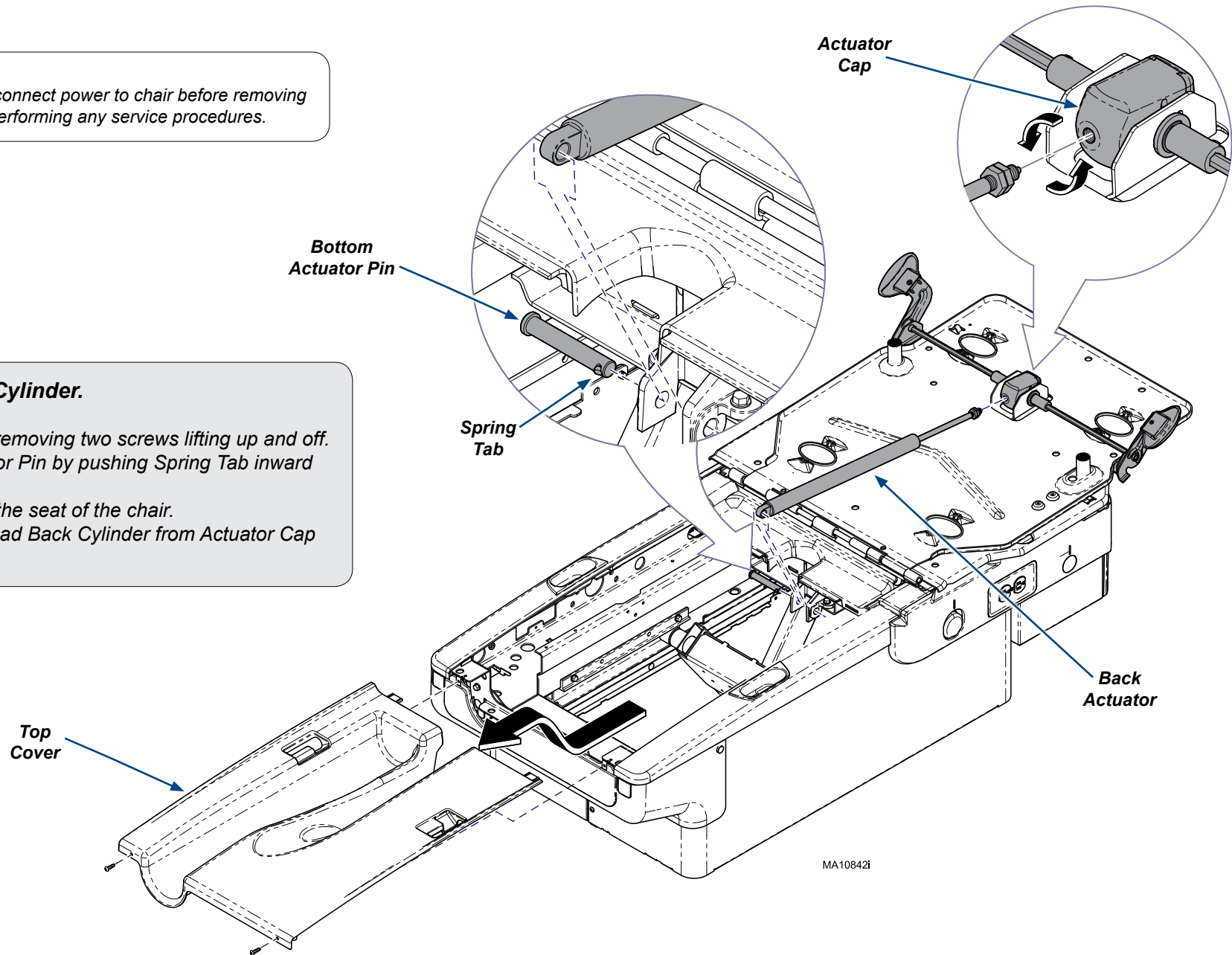

MA10842i

Step 2: Remove Handle, Rod and Bushing.

- A) Remove set screw from Actuator Shaft.
- B) Pull Actuator Handle, Release Rod, and Release Rod Bushing out of chair back. Repeat for opposite side.

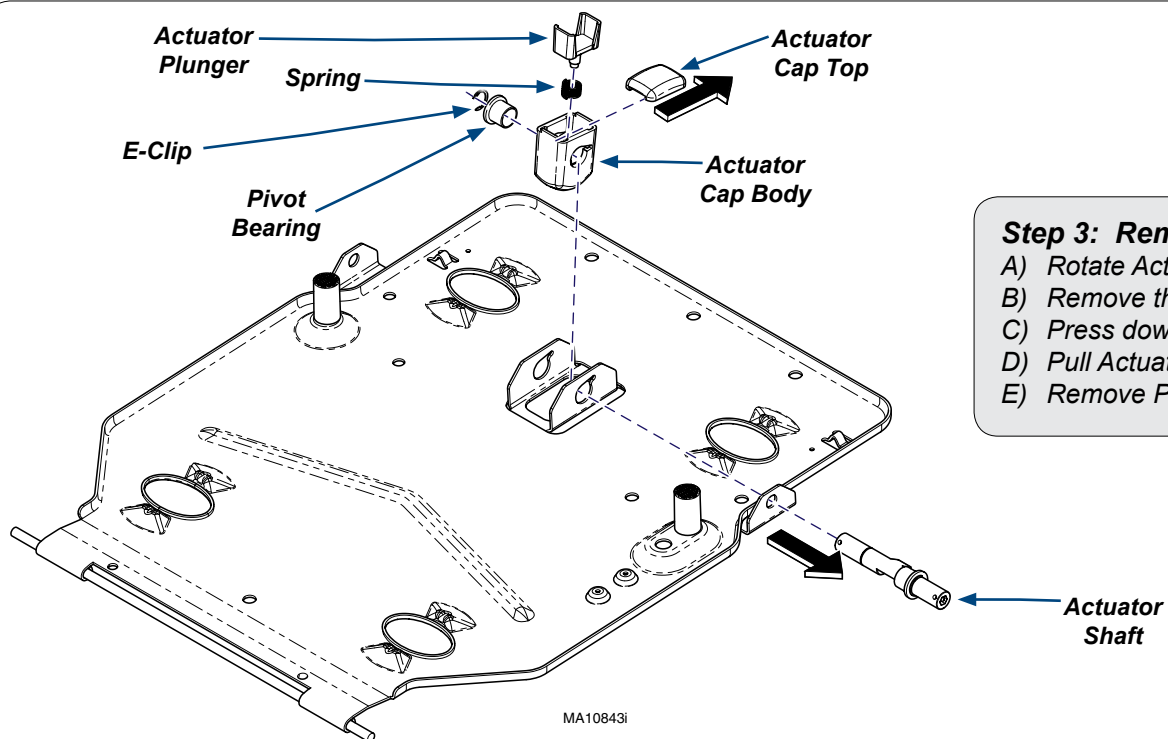
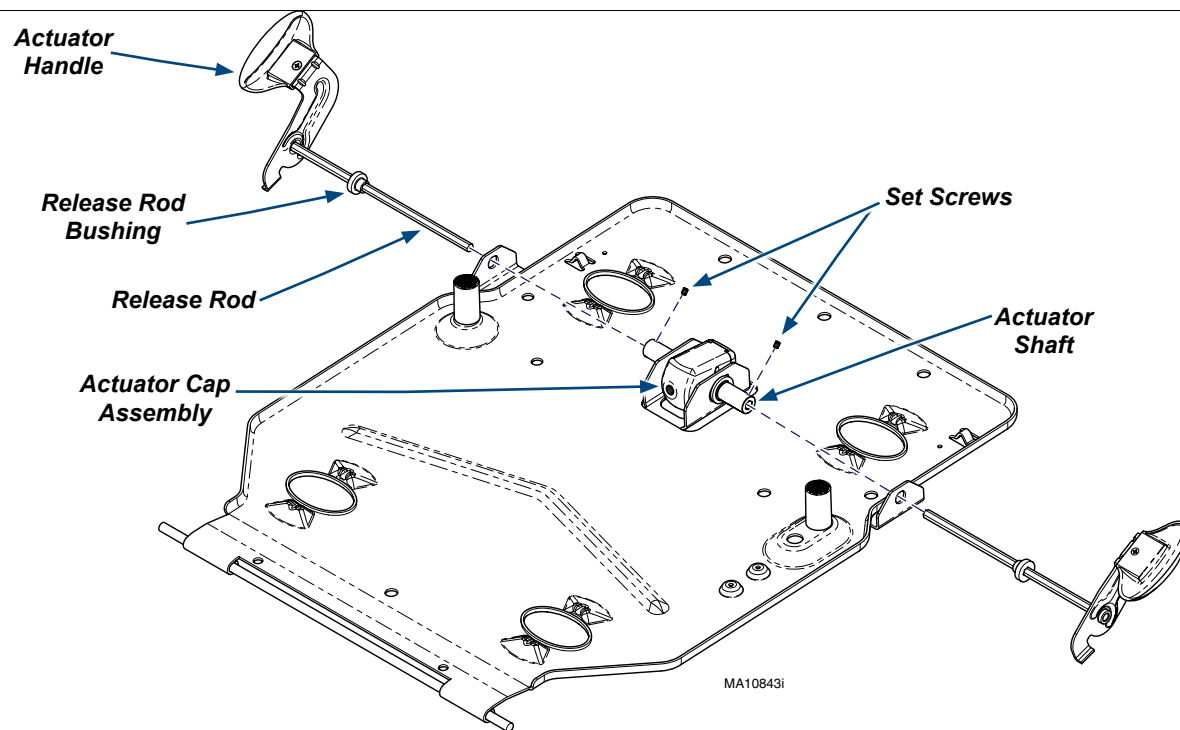

Step 3: Remove Actuator Cap Assembly.

- A) Rotate Actuator Cap Assembly 90° as shown, slide off Actuator Cap Top.
- B) Remove the E-Clip from one side of Actuator Shaft.
- C) Press down on Actuator Plunger to compress Spring.
- D) Pull Actuator Shaft out of Pivot Bearing, chair back and Actuator Cap Body.
- E) Remove Pivot Bearings, Actuator Cap Body, Actuator Plunger and Spring.

Step 4: Reassemble Actuator cap (Reverse Order).

- A) Install Spring and Actuator Plunger into the Actuator Cap Body and position into chair back. Align shaft cut outs.
- B) Press down on Actuator Plunger compressing spring, Insert Actuator Shaft through chair back and Actuator Cap Body.
- C) Insert Pivot Bearings and E-Clips locking Actuator shaft in place.
- D) Install Actuator Cap Top and Rotate Actuator Cap Assembly to line up with cylinder.
- E) Install Actuator Handle, Release Rod, and Release Rod Bushing into chair back and Actuator Shaft, Secure with Set Screw. Repeat on opposite side.

Note

The old Actuator Plunger can be turned upside down and used to push on the new one compressing the spring so Actuator Shaft can be inserted into the Actuator Body.

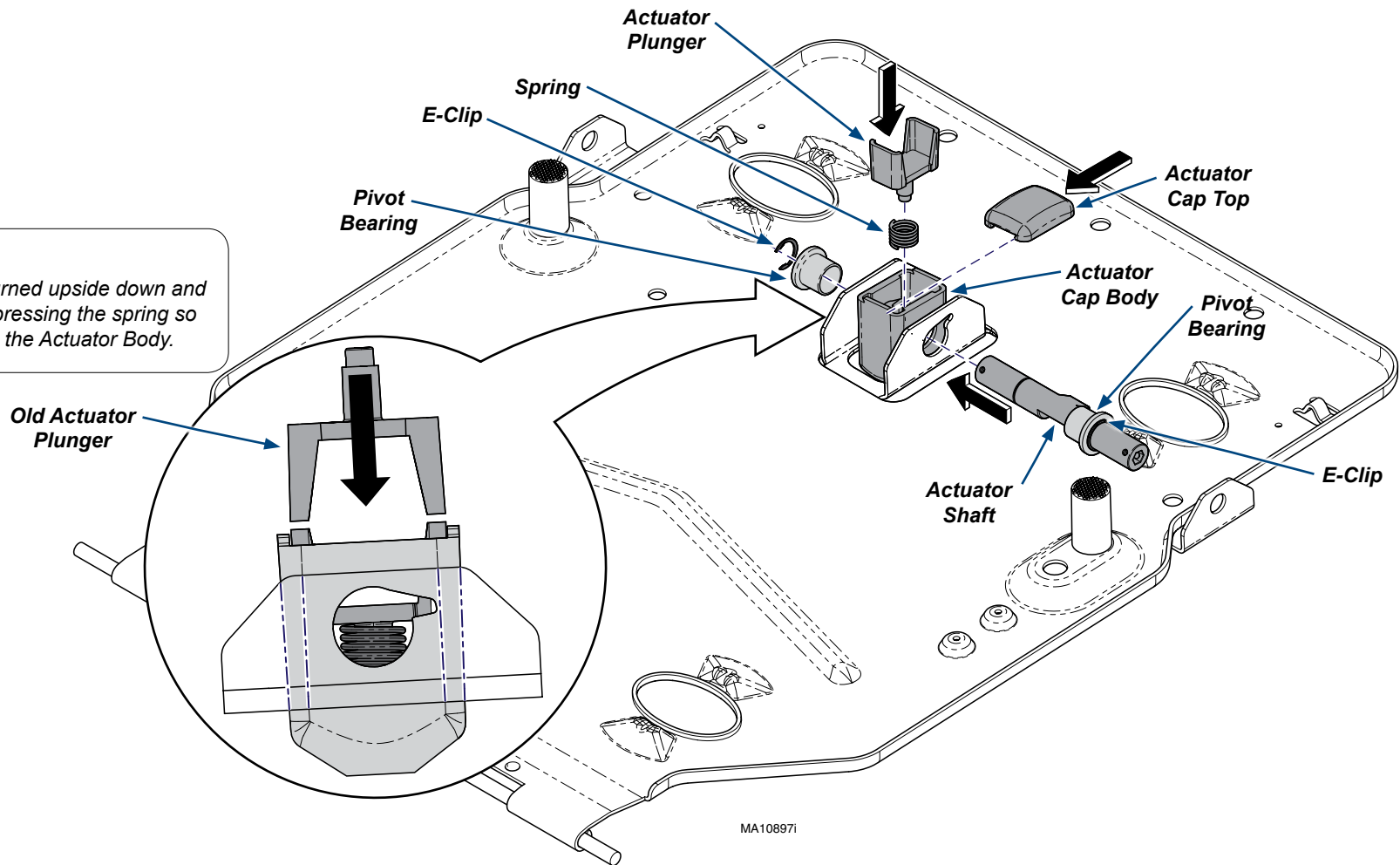

Step 5: Install Cylinder, Cover and Upholstry.(Reverse Order).

- A) Position Back Actuator Jam Nut 5/8" to 11/16" from top of the Plunger.
- B) Rotate Actuator Cap and thread in Back Actuator.
- C) Rotate chair back up, position and secure bottom of Back Actuator with Bottom Actuator Pin.
- D) Test back section adjustment. If it drifts up or down, or is difficult to move proceed to step 6, If adjustment is good then proceed to Step E.
- E) Install Top Cover and secure with two screws.
- F) Install upholstery.

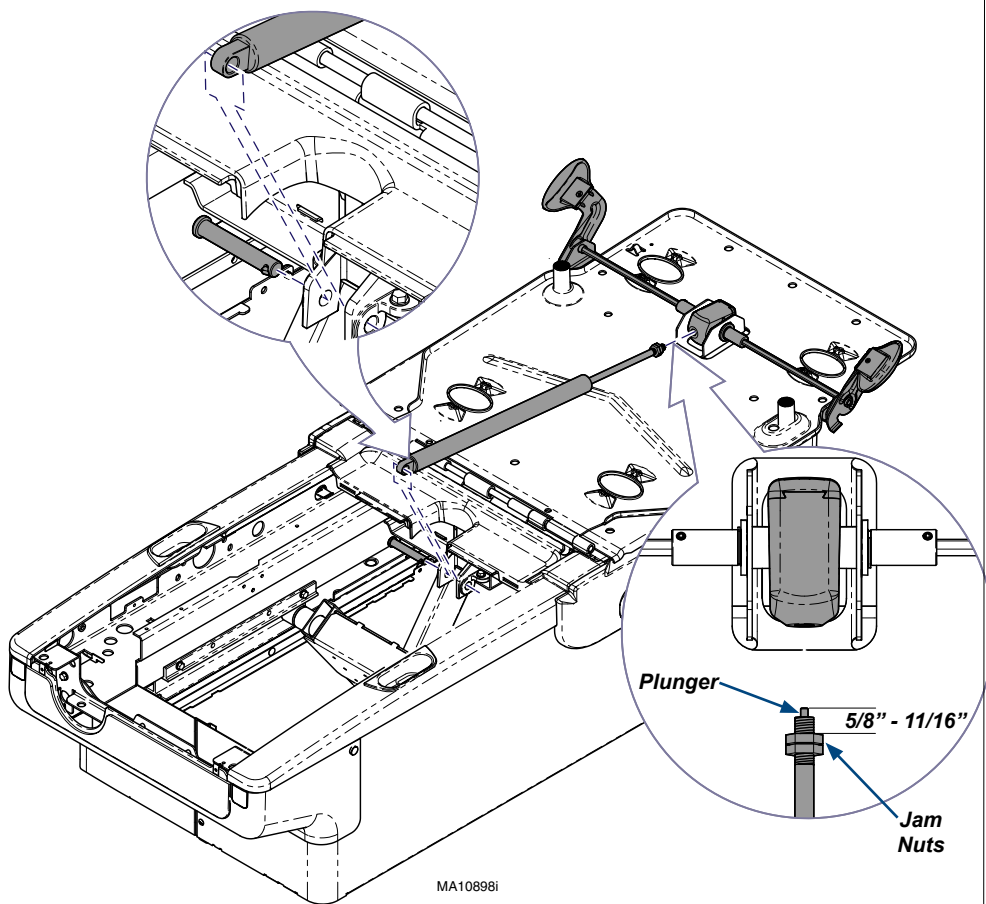

Step 6: Back Adjustment (If Needed).

- A) If Back section drifts up or down, or is difficult to move perform appropriate steps listed below.

If Back section drifts up or down...

- A) Remove clevis pin from bottom of cylinder.
- B) Loosen jam nuts.
- C) Unscrew cylinder slightly.
- D) Tighten jam nuts.
- E) Install clevis pin and test operation.

If Back section 'locked up', or difficult to move...

- A) Remove clevis pin from bottom of cylinder.
- B) Loosen jam nuts.
- C) Screw cylinder in slightly.
- D) Tighten jam nuts.
- E) Install clevis pin and test operation.

